

For Steam, Air and Non-Corrosive Gases

The GD-30 is a compact, high performance direct acting valve. Economical to buy and use, it's ideal for those low to moderate flow applications where accuracy of +/-10% is acceptable. The GD-30 is well suited for laundry and dry cleaning equipment, hospital equipment, tire molds, humidifiers, small heaters and applications in food processing. It provides tight shutoff for dead-end service on steam. Turndown ratio is 10:1 and ANSI Class IV Shutoff.

For a fully detailed certified drawing, refer to:

GD-30 (bronze only) CDY #1038

GD-30S (stainless steel) CDY #1089

Pressure and Temperature Controls

GD-30/30S Specifications

Model Number	Inlet Pressure psig (barg)	Reduced Pressure psig (barg)	Spring Color	Minimum Differential psig (barg)	Application	Maximum Temp. °F (°C)	Materials		
							Body	Valve/Seat	Bellows
GD-30	15 - 250 (1 - 17)	3 - 15 (.21 - 1.0) 7 - 60 (0.5 - 4.0)	Yellow Blue Green	7 (.48)	Steam, Air, Non-Corrosive Gases	410 (210)	Cast Bronze ASTM B584	Stainless Steel AISI 440/304	Phosphor Bronze ASTM B103*
GD-30S	15 - 300 (1 - 20)	50 - 140 (3.4 - 9.6)			Steam, Air, Non-Corrosive Gases	430 (220)	Stainless Steel AISI 316		Stainless Steel AISI 316L

*Stainless steel optional

GD-30/30S Dimensions and Weights

Symbol	Connection Size									
	in	mm	in	mm	in	mm	in	mm	in	mm
	1/2	15	3/4	20	1	25	1-1/2*	40	2*	50
L	3-1/8	80	3-3/8	85	3-3/4	95	5-1/2	140	5-7/8	150
H ₁	2	47	2	47	2	47	3	77	3	77
H	7-1/2	191	7-1/2	191	7-1/2	191	12-1/8	307.1	2-1/8	307
Weight lb (kg)	4-1/4 (1.9)		4-1/4 (1.9)		4-1/2 (2.0)		21-3/8 (9.7)		22 (10)	
C _v	1.3		1.5		2.5		5.6		8.5	

NOTE: GD-30 capacities cannot be determined with a formula—consult capacity tables. Reference note under formula key on page 275.

*GD-30S available in 1/2", 3/4", and 1" only.

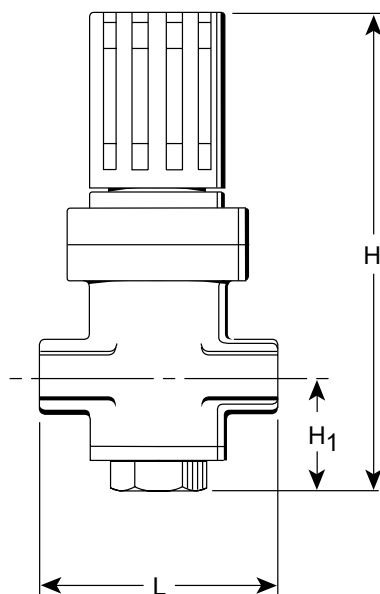

GD-30 Capacities—Steam

		lb/hr							kg/hr				
Inlet	Outlet	Connection Size					Inlet	Outlet	Connection Size				
		in							mm				
psig		1/2	3/4	1	1-1/2	2	barg		15	20	25	40	50
C _v Factor		1.3	1.5	2.5	5.6	8.5	C _v Factor		1.3	1.5	2.5	5.6	8.5
15	7	49	56	92	198	297	1.0	.5	22	25	42	90	135
20	13	53	61	105	216	331	1.4	.9	24	28	48	98	150
	7	42	55	63	180	264		.5	19	25	35	82	120
30	23	62	71	112	242	408	2.0	1.6	28	32	51	110	185
	15	53	60	101	209	309		1.0	24	27	46	95	140
	3	33	40	60	139	216		.2	15	18	27	63	98
40	32	99	121	187	407	617	2.8	2.2	45	55	85	185	280
	20	79	97	159	330	517		1.4	36	44	72	150	235
	4	40	55	77	159	264		.3	18	25	35	72	120
50	40	130	143	242	539	837	3.4	2.8	59	65	110	245	380
	20	99	115	187	407	628		1.4	45	52	85	185	285
	5	48	62	88	193	297		.3	22	28	40	88	135
60	48	137	154	265	584	899	4.0	3.3	62	70	120	265	408
	40	150	165	289	617	969		2.8	68	75	131	280	440
	18	90	104	170	374	584		1.2	41	47	77	170	265
80	6	55	73	99	220	331	5.5	.4	25	33	45	100	150
	64	176	205	342	738	1168		4.4	80	93	155	335	530
	54	187	225	353	782	1201		3.7	85	102	160	355	545
100	23	121	137	220	489	749	6.9	1.6	55	62	100	222	340
	8	60	77	108	231	363		.5	27	35	49	105	165
	80	203	242	397	863	1355		5.5	92	110	180	392	615
120	66	225	262	437	958	1465	8.3	4.5	102	119	198	435	665
	40	198	231	375	837	1278		2.8	90	105	170	380	580
	10	68	79	132	297	473		.7	31	36	60	135	215
150	96	231	276	452	991	1520	10.3	6.6	105	125	205	450	690
	70	276	311	518	1168	1818		4.8	125	141	235	530	825
	45	240	267	450	980	1509		3.1	109	121	204	445	685
180	12	110	121	198	462	705	12.4	.8	50	55	90	210	320
	120	287	333	551	1212	1862		8.3	130	151	250	550	845
	85	364	421	705	1531	2369		5.9	165	191	320	695	1075
200	55	298	353	595	1278	2005	13.8	3.8	135	160	270	580	910
	15	132	165	254	562	848		1.0	60	75	115	255	385
	140	408	485	794	1719	2677		9.7	185	220	360	780	1215
225	115	430	507	860	1829	2832	15.5	8.0	195	230	390	830	1285
	70	386	430	739	1619	2501		4.8	175	195	335	735	1135
	18	165	187	309	683	1035		1.2	75	85	140	310	470
250	140	461	518	871	1983	3063	17.2	9.7	209	235	395	900	1390
	115	474	540	904	2005	3085		8.0	215	245	410	910	1400
	80	430	496	827	1818	2810		5.5	195	225	375	825	1275
275	20	209	242	386	848	1300	18.9	1.4	95	110	175	385	590
	140	485	573	948	2060	3195		9.7	220	260	430	935	1450
	115	496	584	961	2071	3207		8.0	225	265	436	940	1455
300	85	463	540	904	1983	3063	20.0	5.9	210	245	410	900	1390
	23	254	298	496	1079	1675		1.6	115	135	225	490	760
	140	525	606	1014	2226	3438		9.7	238	275	460	1010	1560
300	120	551	584	1038	2248	3471	20.0	8.3	250	265	471	1020	1575
	70	463	529	893	1939	2997		4.8	210	240	405	880	1360
	25	276	320	529	1146	1796		1.7	125	145	240	520	815
300	140	529	613	1023	—	—	20.0	9.7	240	278	464	—	—
	120	529	613	1023	—	—		8.3	240	278	464	—	—
	70	470	542	902	—	—		4.8	213	246	409	—	—
300	28	295	344	562	—	—	20.0	1.9	134	156	255	—	—
	140	529	613	1023	—	—		9.7	240	278	464	—	—
	100	529	613	1023	—	—		6.9	240	278	464	—	—
300	70	478	551	926	—	—	20.0	4.8	217	250	420	—	—
	30	309	359	595	—	—		2.7	140	163	270	—	—

Pressure and Temperature Controls

NOTE: For air capacities scfm, multiply steam capacities (lb/hr) by 0.36. For air capacities m3/hr, multiply steam capacities (kg/hr) by 1.35. Maximum pressure reduction ratio 10:1.

Designs, materials, weights and performance ratings are approximate and subject to change without notice. Visit armstronginternational.com for up-to-date information.