

DIMENSIONS & DATA CERTIFIED FOR:

Representative:

Order:

Customer:

Order:

Project:

Requirements:

By:

Date:

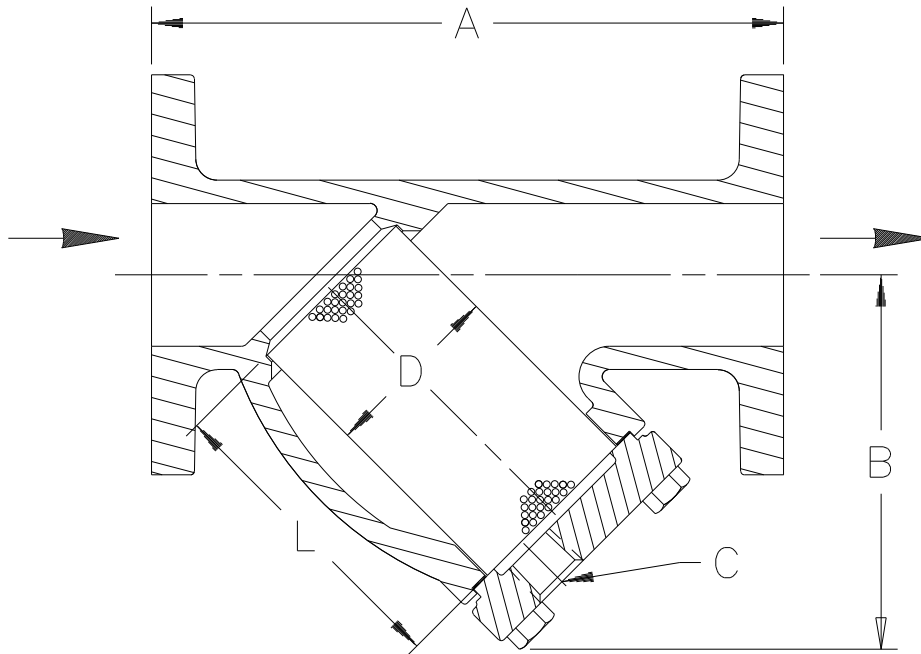

2-1/2" CL. 125 Strainer shown above

Flange Connections ANSI B16.1
Dimensions A & B $\pm 1/8"$ [3mm]

DESCRIPTION	DIMENSIONS							
CONNECTION (FLANGED)	2-1/2" [DN65]	3" [DN80]	4" [DN110]	5" [DN140]	6" [DN170]	8" [DN200]	10" [DN260]	
"A" (FACE TO FACE) [mm]	11-1/16" [281]	12-1/4" [311]	14-7/8" [378]	18-1/8" [460]	20-7/16" [519]	23-3/4" [603]	29-3/8" [746]	
"B" (BOTTOM TO \varnothing INLET) [mm]	6-9/16" [166]	7-1/4" [184]	9-1/2" [241]	11-1/4" [286]	13-7/8" [352]	17-3/4" [451]	21-1/2" [546]	
"C" (BLOW DOWN THREAD)	3/4" NPT [DN20]	1-1/4" NPT [DN32]			1-1/2" NPT [DN40]	2" NPT [DN50]		
"D" (DIA. OF SCREEN) [mm]	3-3/16" [81]	4-3/16" [106]	4-15/16" [125]	6-11/16" [170]	7-11/16" [195]	9-15/16" [252]	12-3/16" [310]	
"L" (LENGTH OF SCREEN) [mm]	5-7/16" [138]	5-5/8" [143]	7-15/16" [202]	9-1/4" [235]	11-1/4" [286]	14-7/8" [378]	19-3/16" [487]	
WEIGHT [kgs]	34 lb [15.5]	50 lb [22.7]	78 lb [35.5]	122 lb [55.5]	178 lb [80.9]	324 lb [147]	566 lb [257]	
MAXIMUM ALLOWABLE PRESSURE (VESSEL DESIGN)	125 psig at 353°F [8.6 bar at 178°C] 175 psig at 150°F [12.1 bar at 65°C]							

LIST OF MATERIALS

NAME OF PART	MATERIAL
BODY	ASTM A48 CL. 30
SCREEN A1FL	T304 SS .045" PERF.
SCREEN A8FL	T304 SS 1/8" PERF.
GASKET, RETAINER	NON-ASBESTOS
RETAINER, BOLTED	ASTM A48 CL. 30
SCREW, CAP	ASTM A193 GR. B7



Armstrong International, Inc.
Three Rivers Division
Three Rivers, MI 49093

Armstrong (269) 273-1415 Fax(269) 278-6555
Posted on Armstrong's homepage www.armstrong-intl.com

Product	CD No.	Date
STRAINER		9/6/96
A1FL 2-1/2" - 8"	1045	Rev. A
A8FL 10"		
CL. 125 CAST IRON		